

NOTICE!!

These documents have been scanned!

Do not place un-scanned documents beneath this notice!

Do not remove this notice from this file!

GPO Jacket No. 560-102
Print Order 61540
Rise Business Services, LLC
Job=AZ15 5/1/2019



Box Number= AZ15013



Claim Begin-End: AMC440245-AMC440245

1 Initial Receipt



AZ15013-10

AMC440098-AMC440515

United States Department of the Interior
Bureau of Land Management
 DIV OF LANDS, MINRLS & ENERGY
 ONE N CENTRAL AVE
 PHOENIX, AZ 85004 -4427
 Phone: 602-417-9200

Receipt

No: 3702520

Transaction #: 3807327	
Date of Transaction: 11/21/2016	
CUSTOMER:	
GRE INC 2091 E MURRAY HOLLADAY RD STE 22E SALT LAKE CITY, UT 84117-5017 US	

NOV 25 2016
R. Am

LINE #	QTY	DESCRIPTION	REMARKS	UNIT PRICE	TOTAL
1	1.00	LOCATABLE MINERALS / MINING CLAIMS-NEW, UNADJUD, ONE OR MORE AUTH NOS / NEW MINING CLAIMS LOCATION FEE CASES: AMC440245/\$37.00		- n/a -	37.00
2	1.00	LOCATABLE MINERALS / MINING CLAIMS-NEW, UNADJUD, ONE OR MORE AUTH NOS / NEW MINING CLAIM PROCESSING FEE CASES: AMC440245/\$20.00		- n/a -	20.00
3	1.00	LOCATABLE MINERALS / MINING CLAIMS-NEW, UNADJUD, ONE OR MORE AUTH NOS / NEW MINING CLAIMS MAINTENANCE FEE CASES: AMC440245/\$155.00		- n/a -	155.00
TOTAL:					\$212.00

PAYMENT INFORMATION			
1	AMOUNT:	212.00	POSTMARKED: N/A
	TYPE:	CHECK	RECEIVED: 11/18/2016
	CHECK NO:	003488	
	NAME:	GRE INC 2091 E MURRAY HOLLADAY RD STE 22E SALT LAKE CITY UT 84117-5017 US	

NOTICE!!

These documents have been scanned!

Do not place un-scanned documents beneath this notice!

Do not remove this notice from this file!

GPO Jacket No. 560-102
Print Order 61540
Rise Business Services, LLC
Job=AZ15 5/1/2019



Box Number= AZ15013



Claim Begin-End: AMC440245-AMC440245

2 Correspondence



AZ15013-10

AMC440098-AMC440515

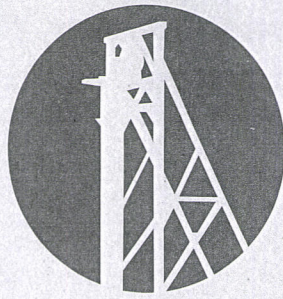

GOLD RUSH EXPEDITIONS

437130
437132
437935
438326
11/15/2017

439949
440223
440245
440367

GRE, Inc.
331 S. Rio Grande Street
Suite #201
SLC, UT 84101

Arizona BLM

Re: Change of Address

Dear Arizona BLM,

Please make a not that GRE Inc. Office has moved. Please change our address to the following

GRE, Inc.
331 S. Rio Grande Street
Suite #201
SLC, UT 84101

We have the following claims

- FESTERLING, AMC437130
- HILLTOP, AMC437134
- MORNING STAR, AMC437935
- BLACK GOLD, AMC438326
- FLAG, AMC439949
- C.O.D., AMC440223
- ARIZONA RAND, AMC440245
- RAWHIDE, AMC440367
- RAWHIDE EXTENSION, AMC440368
- GIBSON EXTENSION, AMC440532
- HOSEY, AMC440534
- JIMMIE, AMC440536
- LUCKY BOY, AMC440538
- MICA GIANT, AMC440539
- NEW STANDARD, AMC440540
- NEW STANDARD EXT, AMC440541

440526
440552
441034
441153
442189
443322

RECEIVED
BLM AZ STATE OFFICE
2011 NOV 20 P 2:31
PHOENIX, ARIZONA

443510
444671

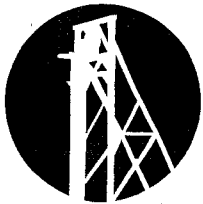

GOLD RUSH

GRE Inc.
331 S. RIO GRANDE ST
SUITE #201
SLC, UT 84101

Arizona BLM
Attn: Cashier
One N. Central Ave., Ste. 800
Phoenix, AZ 85004



US POSTAGE
FIRST CLASS
PERMIT NO. 203
PHOENIX, AZ
88c
NOV 20 2017

RECEIVED
BLM STATE OFFICE
2017 NOV 20 P 2:31
PHOENIX, ARIZONA

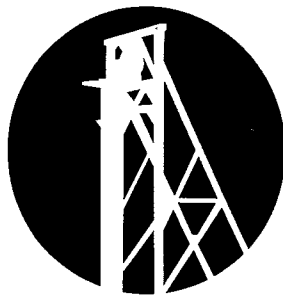

GOLD RUSH EXPEDITIONS

ST LOUIS, AMC440544
TELLURIDE CHIEF, AMC440545
TWILIGHT ZONE, AMC440547
VERDE COMBINATION, AMC440548
YELLOW BREAST, AMC440549
GOLDEN BELT, AMC440552
GOLDEN TURKEY, AMC440553
BULL CANYON, AMC441034
APEX, AMC441153
GREEN STREAK, AMC441154
TALLEY, AMC441155
BLACK MOUNTAIN, AMC442189
CARMELITA, AMC442190
FOUR PEAKS, AMC442191
FOUR PEAKS EXT, AMC442192
GREAT BEAR, AMC442193
JASPER, AMC442194
AGATE AND PALM, AMC443322
ALASKAN, AMC443323
ARRASTRA, AMC443324
ARRASTRA, AMC443325
COPPER QUEEN, AMC443326
PLAMOSA, AMC443330
TEXAS QUEEN, AMC443331
AMBASSADOR, AMC443510
RADIO, AMC443511
UNITED STATES, AMC443512
CARMELITA 1, AMC444671
CARMELITA 2, AMC444672

Thank you for your time and efforts.

Sincerely,

GRE Accounting
385-218-2138
accounting@goldrushexpeditions.com
www.goldrushexpeditions.com

RECEIVED
BLM AZ STAFF OFFICE
2011 NOV 20 P 2:31
PHOENIX, ARIZONA

NOTICE!!

These documents have been scanned!

Do not place un-scanned documents beneath this notice!

Do not remove this notice from this file!

GPO Jacket No. 560-102
Print Order 61540
Rise Business Services, LLC
Job=AZ15 5/1/2019



Box Number= AZ15013



Claim Begin-End: AMC440245-AMC440245

3 Transfers



AZ15013-10

AMC440098-AMC440515

**NO
DOCUMENTS
FOUND**

NO DOCUMENTS FOUND
NO DOCUMENTS FOUND

NOTICE!!

These documents have been scanned!

Do not place un-scanned documents beneath this notice!

Do not remove this notice from this file!

GPO Jacket No. 560-102
Print Order 61540
Rise Business Services, LLC
Job=AZ15 5/1/2019



Box Number= AZ15013



Claim Begin-End: AMC440245-AMC440245

4 Annual Filings



AZ15013-10

AMC440098-AMC440515

**DEPARTMENT OF THE INTERIOR
BUREAU OF LAND MANAGEMENT
MINING CLAIMS**

Run Date/Time: 9/11/2018

**MC Maintenance Fees Paid Through the BLM Pay Portal
(by Date Paid)**

Page 364 Of 723

CBS Receipt: 4248102

Printed For Lead File # AMC440245

Agency Tracking ID: 1535477873

Assessment Year: 2019

Number of BLM Serial Nr: 29

Paid On: 8/28/2018

Total Amount Paid: \$4,495.00

Claim Name	BLM Serial No	Lead File No	Amount Paid
BLACK GOLD	AMC438326	AMC438326	\$155.00
FLAG	AMC439949	AMC439949	\$155.00
C.O.D.	AMC440223	AMC440223	\$155.00
ARIZONA RAND	AMC440245	AMC440245	\$155.00
JIMMIE	AMC440536	AMC440526	\$155.00
LUCKY BOY	AMC440538	AMC440526	\$155.00
NEW STANDARD	AMC440540	AMC440526	\$155.00
NEW STANDARD EXT	AMC440541	AMC440526	\$155.00
ST LOUIS	AMC440544	AMC440526	\$155.00
TELLURIDE CHIEF	AMC440545	AMC440526	\$155.00
VERDE COMBINATION	AMC440548	AMC440526	\$155.00
YELLOW BREAST	AMC440549	AMC440526	\$155.00
GOLDEN BELT	AMC440552	AMC440552	\$155.00
GOLDEN TURKEY	AMC440553	AMC440552	\$155.00
APEX	AMC441153	AMC441153	\$155.00
GREEN STREAK	AMC441154	AMC441153	\$155.00
TALLEY	AMC441155	AMC441153	\$155.00
CARMELITA	AMC442190	AMC442189	\$155.00
FOUR PEAKS	AMC442191	AMC442189	\$155.00
FOUR PEAKS EXT	AMC442192	AMC442189	\$155.00
GREAT BEAR	AMC442193	AMC442189	\$155.00
JASPER	AMC442194	AMC442189	\$155.00
ALASKAN	AMC443323	AMC443322	\$155.00
PLAMOSA	AMC443330	AMC443322	\$155.00

NO WARRANTY IS MADE BY BLM FOR USE OF THE DATA FOR PURPOSES NOT INTENDED BY BLM

DEPARTMENT OF THE INTERIOR
BUREAU OF LAND MANAGEMENT
MINING CLAIMS

Run Date/Time: 9/11/2018

MC Maintenance Fees Paid Through the BLM Pay Portal
(by Date Paid)

Page 365 Of 723

CARMELITA 1	AMC444671	AMC444671	\$155.00
CARMELITA 2	AMC444672	AMC444671	\$155.00
GOLDEN TURKEY 1	AMC447861	AMC447861	\$155.00
GOLDEN TURKEY 2	AMC447862	AMC447861	\$155.00
NEW STANDARD 1	AMC451012	AMC451012	\$155.00

United States Department of the Interior
Bureau of Land Management
 BUSINESS & SUPPORT SVCS DIV
 ONE N CENTRAL AVE SUITE 800
 PHOENIX, AZ 85004 -4427
 Phone: 602-417-9200

Receipt

No: 4248102

Transaction #: 4363576	
Date of Transaction: 08/28/2018	
CUSTOMER:	
JESSICA SHUMAN 1995 RIVER RUN DRIVE HUNTSVILLE, CT 84317 US	

LINE #	QTY	DESCRIPTION	REMARKS	UNIT PRICE	TOTAL
1	1.00	LOCATABLE MINERALS / MINING CLAIMS- NOT NEW-UNADJUD, ONE AUTH NO. ONLY / MINING CLAIM MONEY RECEIVED CASES: AMC439949/\$4495.00		- n/a -	4495.00
TOTAL:					\$4,495.00

PAYMENT INFORMATION			
NOTE: Items will appear on credit card statement as "BLM O Mining Claim".			
1	AMOUNT:	4495.00	POSTMARKED: N/A
	TYPE:	CREDIT CARD	RECEIVED: 08/28/2018
	NAME:	JESSICA SHUMAN 1995 RIVER RUN DRIVE HUNTSVILLE CT 84317 US	
	CARD NO:	XXXXXXXXXXXX3699	AUTH CODE: 029750
	NAME ON CARD:	JESSICA SHUMAN	
	SIGNATURE:		

REMARKS

This receipt was generated by the automated BLM Collections and Billing System and is a paper representation of a portion of the official electronic record contained therein.

Run Date: 08/09/17

Run Time: 02:20 PM

**DEPARTMENT OF THE INTERIOR
BUREAU OF LAND MANAGEMENT
MINING CLAIMS**

MC Maintenance Fees Paid Through the BLM Pay Portal

CBS Receipt: 3917326

Printed For Lead File # AMC440245

Agency Tracking ID: 1501613952

Number of BLM Serial Nr: 24

Assessment Year: 2018

Total Amount Paid: \$3,720.00

Paid On: 08/01/2017

Claim Name	BLM Serial No	Lead File No	Amount Paid
BLACK GOLD	AMC438326	AMC438326	\$155.00
ARIZONA RAND	AMC440245	AMC440245	\$155.00
GIBSON EXTENSION	AMC440532	AMC440526	\$155.00
NEW STANDARD	AMC440540	AMC440526	\$155.00
NEW STANDARD EXT	AMC440541	AMC440526	\$155.00
ST LOUIS	AMC440544	AMC440526	\$155.00
TELLURIDE CHIEF	AMC440545	AMC440526	\$155.00
TUSCUMBIA	AMC440546	AMC440526	\$155.00
TWILIGHT ZONE	AMC440547	AMC440526	\$155.00
VERDE COMBINATION	AMC440548	AMC440526	\$155.00
YELLOW BREAST	AMC440549	AMC440526	\$155.00
GOLDEN TURKEY	AMC440553	AMC440552	\$155.00
TALLEY	AMC441155	AMC441153	\$155.00
CARMELITA	AMC442190	AMC442189	\$155.00
FOUR PEAKS	AMC442191	AMC442189	\$155.00
FOUR PEAKS EXT	AMC442192	AMC442189	\$155.00
GREAT BEAR	AMC442193	AMC442189	\$155.00
AGATE AND PALM	AMC443322	AMC443322	\$155.00
ALASKAN	AMC443323	AMC443322	\$155.00
GOLD RANGE	AMC443327	AMC443322	\$155.00
RADIO	AMC443511	AMC443510	\$155.00
UNITED STATES	AMC443512	AMC443510	\$155.00
CARMELITA 1	AMC444671	AMC444671	\$155.00
CARMELITA 2	AMC444672	AMC444671	\$155.00

**United States Department of the Interior
Bureau of Land Management
BUSINESS & SUPPORT SVCS DIV
ONE N CENTRAL AVE SUITE 800
PHOENIX, AZ 85004 -4427
Phone: 602-417-9200**

Receipt

No: 3917326

Transaction #: 4026792	
Date of Transaction: 08/01/2017	
CUSTOMER:	
	CRYSTAL SUTTON 2091 E MURRAY HOLLADAY RD SLC,UT 84117 US

LINE #	QTY	DESCRIPTION	REMARKS	UNIT PRICE	TOTAL
1	1.00	LOCATABLE MINERALS / MINING CLAIMS- NOT NEW-UNADJUD, ONE AUTH NO. ONLY / MINING CLAIM MONEY RECEIVED CASES: AMC442190/\$3720.00		- n/a -	3720.00
TOTAL:					\$3,720.00

PAYMENT INFORMATION			
NOTE: Items will appear on credit card statement as "BLM O Mining Claim".			
1	AMOUNT:	3720.00	POSTMARKED: N/A
	TYPE:	CREDIT CARD	RECEIVED: 08/01/2017
	NAME:	CRYSTAL SUTTON 2091 E MURRAY HOLLADAY RD SLC UT 84117 US	
	CARD NO:	XXXXXXXXXXXX4138	AUTH CODE: 026942
	NAME ON CARD:	CRYSTAL SUTTON	
	EXPIRES:	12/2019	
	SIGNATURE:		

REMARKS

This receipt was generated by the automated BLM Collections and Billing System and is a paper representation of a portion of the official electronic record contained therein.

NOTICE!!

These documents have been scanned!

Do not place un-scanned documents beneath this notice!

Do not remove this notice from this file!

GPO Jacket No. 560-102
Print Order 61540
Rise Business Services, LLC
Job=AZ15 5/1/2019



Box Number= AZ15013



Claim Begin-End: AMC440245-AMC440245

5 Miscellaneous



AZ15013-10

AMC440098-AMC440515

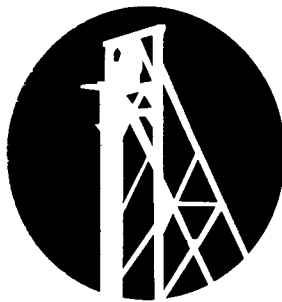

11/15/2016

GOLD RUSH EXPEDITIONS

GRE, Inc.
2091 E. Murray Holladay Road
Suite #22E
SLC, UT 84117

RUSH

ARIZONA BLM

Re: ONE Notice of Location(s)

Dear ARIZONA BLM Cashier,

Please find enclosed ONE Notice of location (s) for filing. I understand there is a fee for recording each of these documents. I have enclosed a check for the fees. Please apply the appropriate amount owed for filing fees and send a receipt with the recorded documents.

I have also enclosed a postage paid envelope for the document(s) to be returned.

Thank you for your time and efforts.

Sincerely,

GRE Accounting
385-218-2138
accounting@goldrushexpeditions.com
www.goldrushexpeditions.com

RECEIVED
BLM STATE OFFICE
2016 NOV 18 P 2:34
PHOENIX, ARIZONA

AMC440245

NOTICE!!

These documents have been scanned!

Do not place un-scanned documents beneath this notice!

Do not remove this notice from this file!

GPO Jacket No. 560-102
Print Order 61540
Rise Business Services, LLC
Job=AZ15 5/1/2019



Box Number= AZ15013



Claim Begin-End: AMC440245-AMC440245

6 Location Notices-Amendments and Supporting Documents



AZ15013-10

AMC440098-AMC440515

MINING CLAIM STATUS REPORT

Data Entered: 11/25/16 RAm

MTP Checked By: 8/21/17 PJB
GEO Checked By: 11/25/16 RAm

LEAD SERIAL NUMBER: AMC 440245 thru AMC _____

NUMBER OF CLAIMS & TYPE:

CHARGES:

1 LODE
____ PLACER
____ ASSOCIATION PLACER
____ MILL SITE
____ TUNNEL SITE

Location Fee @ \$37 = \$ 37.00
Processing Fee @ \$20 = \$ 20.00
Maintenance Fee @ \$155 = \$ 155.00
Add'l Maint Fee for Assoc Placer = \$ _____
SUBTOTAL \$ 212.00
Other Fees \$ _____
Other Fees \$ _____
TOTAL \$ 212.00

TOTAL ACREAGE: N/A Per Claim
(Placer Only)

NUMBER OF LOCATORS: 1

DOCUMENTS RECEIVED VIA: Over-the-Counter [] Mail [] TIMELY FILED: Yes [] No []

LEGAL DESCRIPTION: T 21N R 21W SEC 11, 12
T _____ R _____ SEC _____
T _____ R _____ SEC _____
T _____ R _____ SEC _____
T _____ R _____ SEC _____

BLM [] FOREST SERVICE [] _____ SUBJ TO PL 359: Yes [] No []
WILDERNESS AREA [] _____

SPLIT ESTATE: N/A [] SX [] PX [] OTHER [] _____
SRHA [] Was proper Notice filed if located on SHRA Land? Yes [] No []

RECONVEYED MINERALS ON BLM LAND REQUIRE OPENING ORDER FROM 1944 TO 1993:

Open to Entry On _____ N/A []

COMMENTS/STATUS: VOID [] PARTIALLY VOID [] PVT MINERALS [] WITHDRAWN LANDS []
OTHER [] No rights given within sec 12 (APLN/ME PATENT) A-23007.

[] Claimant acknowledges that portions of the following claim(s) site(s) may be void or voidable.

Printed Name of Claimant _____ Signature of Claimant _____

*****FINAL ADJUDICATION*****

DATE 8/21/17 INITIALS PJB

440245

LOCATION NOTICE FOR LODE MINING CLAIM

NOTICE IS HEREBY GIVEN that the ARIZONA RAND

lode mining claim has been located by

GRE INC whose current mailing

address is 2091 E Murray Holladay Road Suite 22E, SLC, UT 84117.

The general course of this claim is EAST TO WEST and it is

situated in MOHAVE County, Arizona. This claim is 1500 feet in length and 600 feet in width.

The ARIZONA RAND Lode Mining Claim is located pursuant to 43 C.F.R. 3832.12 (b), and described by metes and bounds, including a description of the tie to an official survey monument as follows: Beginning at Northeast corner #1, thence 600 feet south at 180° to Southeast corner #2, thence 1500 feet west at 270° to Southwest corner #3, thence 600 feet north at 0°, to Northwest corner #4, thence 1500 feet east at 90° back to Northeast corner #1, place of beginning.

Tie Point: Beginning at T 21N R 21W survey monument for corner of sections 1, 2, 11, 12 thence South 20° 37 minutes 13 seconds East a distance of 2,120 feet to claim corner #1.

The location monument on which this notice is posted is situated within Section 11, Township 21N, Range 21W, Gila Salt River Base and Meridian, Arizona and this claim encompasses portions

of the following quarter section (s), section (s), Township (s) and Range (s) NE ¼ OF SECTION 11 T21N R21W & NW ¼ OF SECTION 12 T21N R21W

Gila and Salt River Meridian, Arizona.

This Notice of Location has been written to capture mineral rights within its boundaries, only on open and locatable ground. In the case that some or parts of the claim boundaries overlap private or patented land it is understood that no rights or ownership is implied or assumed in relation to that portion of the claim. In the case that any part of this claim boundary may overlap another, pre-existing claim, it is understood that no rights or ownership is implied or assumed in relation to that portion of the claim. Any overlap or overstaking that has occurred is solely due to standard sizing of claims and there is no claim or ownership implied or assumed.

DATED AND POSTED on the ground this 30TH day of SEPTEMBER, 2016.

LOCATOR (s) 
Crystal Sutton (agent for GRE Inc)

BLM	
Date	
Stamp	

RECEIVED
BLM AZ STATE OFFICE
2016 NOV 18
PHOENIX, ARIZONA

AMC440245

MINING CLAIM MAP

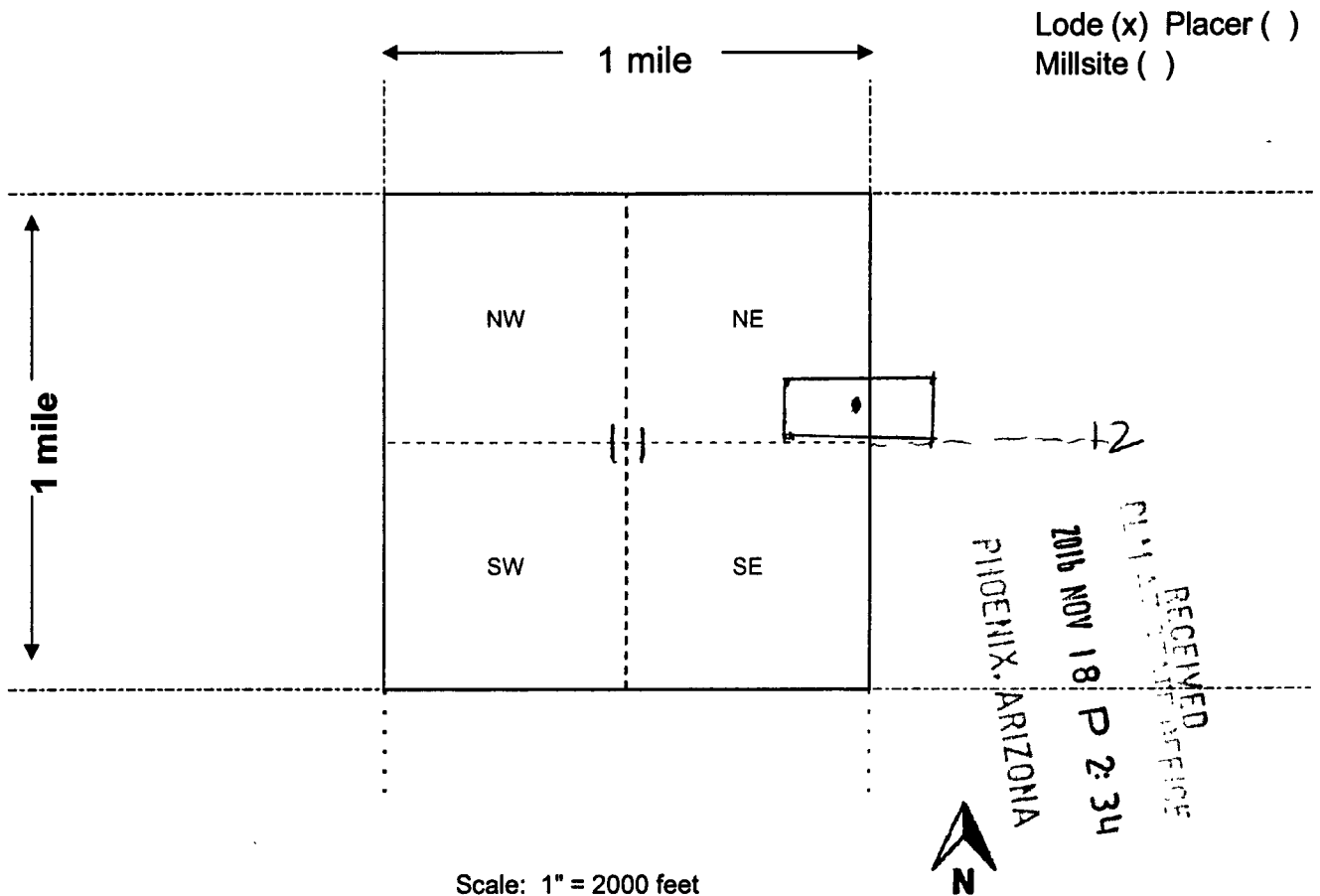

AMC 440245

1. The above map depicts the ARIZONA RAND LODE mining claim, which is located in Section 11 & 12 Township 21N, Range 21W, Gila and Salt River Base and Meridian, MOHAVE County, Arizona. Total claim acreage is 20.66

2. The type of corner and location monuments used are as follows: 2"X2" WOODEN STAKES
WITH FLAGGING

3. The bearings and distances in degrees and feet between claim corners and to a public land survey monument are as depicted on the map.

4. If the claim is a placer or millsite claim with exterior limits conforming to legal subdivisions of the public survey, provide a legal description of the claim _____

Form MCF100a
Revised July 2014

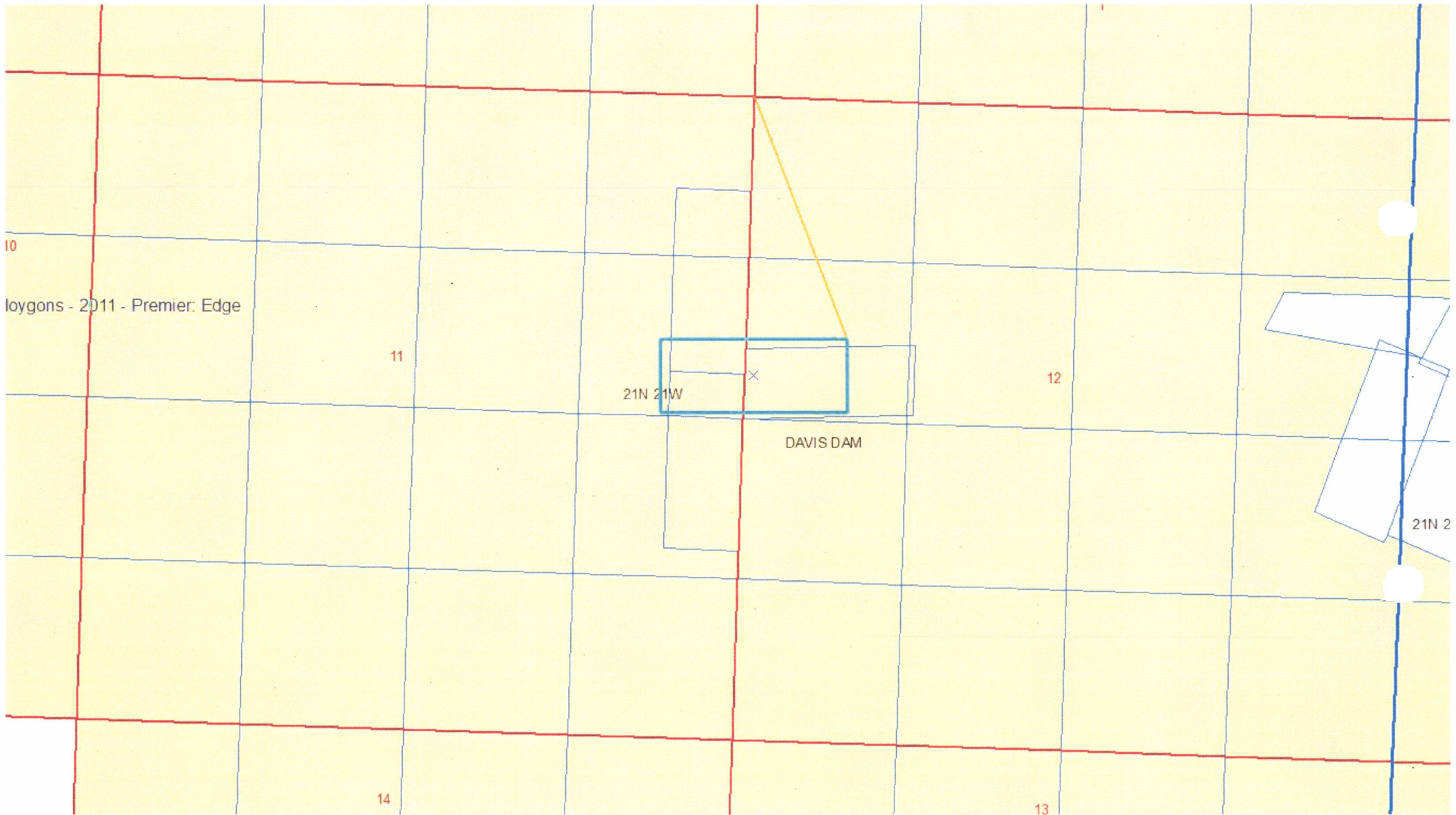

8/8/17
Greg Smith

U.S. DEPARTMENT OF THE INTERIOR
BUREAU OF LAND MANAGEMENT
General Land Office Records

Search Documents Reference Center Support Shopping Cart

Search Documents Survey Details

DM ID: 364627 Survey Type: Mineral Survey Survey Title: Gold Slab # 1, L & L # 4,7 Lodes State: Arizona

Survey Plat Details Plat Image Related Documents

Sheet: 1 Original

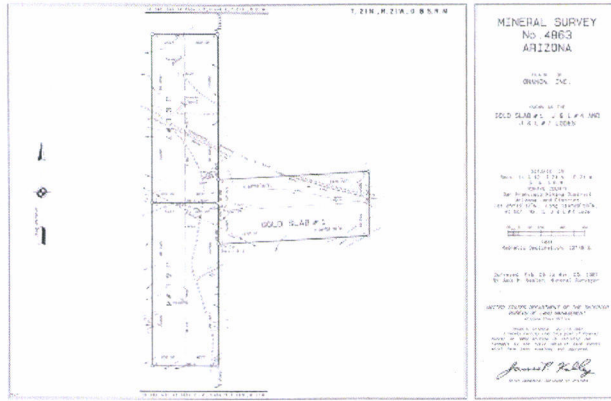

6.25%

zoom

Javascript Viewer

Plugin Viewer

Basic Viewer



Note: You can download our plat images directly by clicking one of the icons above. Check out our [Viewing And Printing Images Guide](#) for more information.

Input Parameters for Geographic Report with Land

System Id = CR

Admin State = AZ

Geo State = AZ

Casetype Begins With

Case Disp Txt = AUTHORIZED, CANCELLED, EXPIRED, PENDING, REJECTED, RELINQUISHED, WITHDRAWN

Mer Twp Rng =

Section =

Mtrs = 14 0210N 0210W 011, 14 0210N 0210W 012, 14 0210N 0210W 999

Commodity =

Commodity Txt =

Pending Org =

Pend Org Decode =

Total Rows Returned: 8

RUN TIME: 08:54 AM

UNITED STATES DEPARTMENT OF INTERIOR
BUREAU OF LAND MANAGEMENT
GEOGRAPHIC REPORT WITH LAND
Sorted by Meridian Township Range

RUN DATE: 08/07/2017

Page 1 of 1

Adm State: AZ

Serial Number: AZA 006402

Total Case Acres: 3.700

<u>Casetype</u>	<u>Case Disp</u>	14	0210N	0210W	<u>Sect</u>	<u>Sur Typ</u>	<u>Sur Num</u>	<u>Suff</u>	<u>Subdivision</u>	<u>Act Pend</u>
285002	AUTHORIZED				011	ALIQ			NWSE;	
						ALIQ		1	SESW;	
						MNR		1	S2SENE,NWNESE,	
						MNR		2	NWSWSE,	

Serial Number: AZA 015014

Total Case Acres: 13.100

<u>Casetype</u>	<u>Case Disp</u>	14	0210N	0210W	<u>Sect</u>	<u>Sur Typ</u>	<u>Sur Num</u>	<u>Suff</u>	<u>Subdivision</u>	<u>Act Pend</u>
286203	AUTHORIZED				011	ALIQ			N2;	
					012	ALIQ			N2;	

Serial Number: AZPHX 0034352

Total Case Acres: 424.177

<u>Casetype</u>	<u>Case Disp</u>	14	0210N	0210W	<u>Sect</u>	<u>Sur Typ</u>	<u>Sur Num</u>	<u>Suff</u>	<u>Subdivision</u>	<u>Act Pend</u>
285003	AUTHORIZED				011	ALIQ			N2;	
					012	ALIQ			N2,SW;	

TOWNSHIP 21 NORTH RANGE 21 WEST OF THE GILA & SALT RIVER MERIDIAN, ARIZONA

SECS	SUBDIVISION																Acres	Kind of Entry or Purpose	Serial Number or Order Number	Action Date	Remarks		
	NE 1/4				NW 1/4				SW 1/4				SE 1/4									Lots	Other Description
	NE	NW	SW	SE	NE	NW	SW	SE	NE	NW	SW	SE	NE	NW	SW	SE							
For orders affecting disposal or use of unidentified lands withdrawn for classification, minerals, water, and/or other public purposes, and Indian treaties, refer to Index to Miscellaneous Documents																							
1																	M&B,						
2																	ALL,						
3																	ALL,						
4																	ALL,						
5																	ALL,						
6																	ALL,						
7																	ALL,						
8																	ALL,						
9																	ALL,						
10																	ALL,						
11																	ALL,						
12																	M&B,						
13																	M&B,						
14																	ALL,						
15																	ALL,						
16																	ALL,						
17																	ALL,						
18																	ALL,						
19																	ALL,						
20																	ALL,						
21																	ALL,						
22																	ALL,						
23																	ALL,						
24																	ALL,						
25																	ALL,						
26																	ALL,						
27																	ALL,						
28																	ALL,						
29																	ALL,						
30																	ALL,						
31																	ALL,						
32																	ALL,						

TOWNSHIP 21 NORTH RANGE 21 WEST OF THE GILA & SALT RIVER MERIDIAN, ARIZONA

SECS	SUBDIVISION																Lots	Other Description	Acres	Kind of Entry or Purpose	Serial Number or Order Number	Action Date	Remarks		
	NE 1/4				NW 1/4				SW 1/4				SE 1/4												
	NE	NW	SW	SE	NE	NW	SW	SE	NE	NW	SW	SE	NE	NW	SW	SE									
	For orders affecting disposal or use of unidentified lands withdrawn for classification, minerals water, and/or other public purposes, and Indian treaties, refer to Index to Miscellaneous Documents																								
33																			ALL,						
34																			ALL,						
35																			ALL,						
36																			ALL. ALL LANDS WITHIN 6 MILES OF COLORADO RIVER WEST OF 114 TH MER.		SO TEMP WDL COLORADO RIVER SURVEY		1/31/1903	7S 20W, REV SO 9/15/1919,	
1																			M&B,						
2																			ALL,						
3																			ALL,						
4																			ALL,						
5																			ALL,						
6																			ALL,						
7																			ALL,						
8																			ALL,						
9																			ALL,						
10																			ALL,						
11																			ALL,						
12																			M&B,						
13																			M&B,						
14																			ALL,						
15																			ALL,						
16																			ALL,						
17																			ALL,						
18																			ALL,						
19																			ALL,						
20																			ALL,						
21																			ALL,						
22																			ALL,						
23																			ALL,						
24																			ALL,						
25																			ALL,						
26																			ALL,						
27																			ALL,						

TOWNSHIP 21 NORTH RANGE 21 WEST OF THE GILA & SALT RIVER MERIDIAN, ARIZONA

SECS	SUBDIVISION																Acres	Kind of Entry or Purpose	Serial Number or Order Number	Action Date	Remarks		
	NE 1/4				NW 1/4				SW 1/4				SE 1/4									Lots	Other Description
	NE	NW	SW	SE	NE	NW	SW	SE	NE	NW	SW	SE	NE	NW	SW	SE							
For orders affecting disposal or use of unidentified lands withdrawn for classification, minerals, water and/or other public purposes, and Indian treaties, refer to Index to Miscellaneous Documents																							
7																	ALL,						
8																	ALL,						
9																	ALL,						
10																	ALL,						
11																	ALL,						
12																	M&B,						
13																	M&B,						
14																	ALL,						
15																	ALL,						
16																	ALL,						
17																	ALL,						
18																	ALL,						
19																	ALL,						
20																	ALL,						
21																	ALL,						
22																	ALL,						
23																	ALL,						
24																	ALL,						
25																	ALL,						
26																	ALL,						
27																	ALL,						
28																	ALL,						
29																	ALL,						
30																	ALL,						
31																	ALL,						
32																	ALL,						
33																	ALL,						
34																	ALL,						
35																	ALL,						
36																	ALL, ALL LANDS WITHIN 6 MILES OF COLORADO RIVER		O REST COLORADO RIVER SURVEY AND COLORADO RIVER PROJECT, SO 9/15/1919	9/27/1919	OPEN TO ENTRY, 11N 18W		
6																	MS 3264, 21N 22W,	59.898	PATENT / ME	724555	12/18/1919		

TOWNSHIP 21 NORTH RANGE 21 WEST OF THE GILA & SALT RIVER MERIDIAN, ARIZONA

SECS	SUBDIVISION																Lots	Other Description	Acres	Kind of Entry or Purpose	Serial Number or Order Number	Action Date	Remarks
	NE 1/4				NW 1/4				SW 1/4				SE 1/4										
	NE	NW	SW	SE	NE	NW	SW	SE	NE	NW	SW	SE	NE	NW	SW	SE							
For orders affecting disposal or use of unidentified lands withdrawn for classification, minerals water and/or other public purposes, and Indian treaties, refer to Index to Miscellaneous Documents																							
6																	MS 3638A, 21N 22W,	99 346	PATENT / ME	984943	9/9/1926		
																	ALL SECS 2, 16, 32, 36		STATE GRANT	ACT OF CONGRESS	1/25/1927	EXTENDS ACT OF 6/20/1910 TO MINERAL LANDS, SUBJECT TO PRIOR RIGHTS	
3																							
4																	MS 3985,	99 657	PATENT / ME	1007192	9/12/1927		
5																							
6																	MS 4028,	25 39	PATENT / ME	1016827	6/6/1928		
2																							
3																	MS 4055, 22N 21W,	68 124	PATENT / ME	1034423	1/28/1930		
4																	ALL,						
5																	ALL,						
6																	ALL,						
7																	ALL,						
8																	ALL,						
9																	ALL,						
16																	ALL,						
17																	ALL,						
18																	ALL,						
19																	ALL,						
20																	ALL,						
21																	ALL,						
28																	ALL,						
29																	ALL,						
30																	ALL,						
31																	ALL,						
32																	ALL,						
33																	ALL, EXCEPTING ANY TRACT, THE TITLE TO WHICH HAS PASSED OUT OF THE US,		SO WDL COLORADO RIVER STORAGE PROJECT		6/4/1930	3S 23W, REV SO 8/27/1931, PART REV 9/26/1983,	
4																	ALL,						
5																	ALL,						
6																	ALL,						
7																	ALL,						

TOWNSHIP 21 NORTH RANGE 21 WEST OF THE GILA & SALT RIVER MERIDIAN, ARIZONA

SECS	SUBDIVISION																Acres	Kind of Entry or Purpose	Serial Number or Order Number	Action Date	Remarks			
	NE 1/4				NW 1/4				SW 1/4				SE 1/4									Lots	Other Description	
	NE	NW	SW	SE	NE	NW	SW	SE	NE	NW	SW	SE	NE	NW	SW	SE								
For orders affecting disposal or use of unidentified lands withdrawn for classification, minerals, water, and/or other public purposes, and Indian treaties, refer to Index to Miscellaneous Documents																								
33																		EXCEPTING ANY TRACT, THE TITLE TO WHICH HAS PASSED OUT OF THE US,		SO WDL COLORADO RIVER STORAGE PROJECT		10/16/1931	10N 18W, MOD 8/16/1944, PART REV 4/22/1971, PLO MOD 12/6/1972, PART REV PLO 6338 9/20/1982, PART REV 9/26/1983,	
6									X				X											
7																		ALL,						
18																		ALL,						
19																		ALL,						
20					X	X					X	X						31N 17W,		SO WDL PWR SITE CL	272	5/29/1933	PART REV O 9/29/1947,	
2																								
3																								
4																								
5																								
6																								
11																								
12																		M&B, SUBDIV UNDEF,		RW TELEPHONE AND TELEGRAPH LINE	PHX-066944	7/15/1933	21N 22W PART REL 1/17/1950, REL 5/9/1973,	
5																		ALL,						
6																		ALL,						
7																		ALL,						
8																		ALL,						
17																		ALL,						
18																		ALL,						
19																		ALL,						
20																		ALL, 31N 17W,		O REV PWR PROJECT 258, O 12/14/1921		11/14/1934		
2																	PART 4	10S 18E,	5 56	IL BASE	130	1/16/1935		
5																		MS 4017,	36 576	PATENT / ME	1081141	1/28/1936		
22					X													NORTH OF HWY, N2SESE SOUTH OF HWY,		RW MATERIAL SITE	PHX-083063	1/24/1947	PART REL N2SESE SOUTH OF HWY, REL 11/3/1977,	
28									X	X	X	X							160 00					
30	X	X	X	X	X				X	X			X	X	X	X		16N 20W	480 00	O REV PWR SITE CL 55 (AR-2), SO 6/22/1923	89	9/29/1947	REST O 11/14/1952,	
6									X				X		X	X			386 13					
7	X	X	X	X	X								X	X	X	X	1		447 50					

TOWNSHIP 21 NORTH RANGE 21 WEST OF THE GILA & SALT RIVER MERIDIAN, ARIZONA

SECS	SUBDIVISION																Acres	Kind of Entry or Purpose	Serial Number or Order Number	Action Date	Remarks				
	NE 1/4				NW 1/4				SW 1/4				SE 1/4									Lots	Other Description		
	NE	NW	SW	SE	NE	NW	SW	SE	NE	NW	SW	SE	NE	NW	SW	SE									
	For orders affecting disposal or use of unidentified lands withdrawn for classification, minerals, water, and/or other public purposes, and Indian treaties, refer to Index to Miscellaneous Documents																								
30	X																								
31																		M&B,	1 03	MOU BLM, RECL AND POSTAL SERVICE FOR POST OFFICE SITE	A-9274	10/3/1975	PERPETUAL, OTHER TPS 20N 21W, 19N 21W, 18N 21W, 18N 20W, 17N 20W, 16 1/2N 20 1/2W, 16N 20W, 15N 20W, 14N 20W, 14N 19W, 13N 19W, 12N 19W, 12N 18W, 11N 18W,		
28																		S2S2N2,		R/W BURIED TELEPHONE CABLE	A-9222	3/1/1976	TO TERM 2/18/2026,		
30												X			X	X	4								
31																	1-4			R/W BURIED TELEPHONE CABLE	A-9239	3/1/1976	TO TERM 2/28/2026, AMENDED 7/23/1980, AMENDED 5/19/1981,		
2									X	X							12								
3																		8, 9, 1 LESS PATENTED MS 4055	22N 21W	R/W ELECTRIC DISTRIBUTION LINE	A-9775	6/17/1977	TO TERM 6/16/2007,		
14																		PART SESWSE,	10 00	FREE USE PERMIT	A-10809	4/23/1979	EXPIRED 6/25/1981		
2									X	X															
3									X	X			X	X	X	X		8, 9, 1 EXCEPT PATENTED MS,							
11	X	X	X	X	X	X	X	X																	
12	X	X	X	X	X	X	X	X										21N 20W,		R/W BURIED TELEPHONE CABLE	A-15014	3/12/1981	TO TERM 3/11/2011,		
19					X	X	X	X	X	X	X	X						SWSWSE							
30	X	X													X	X									
31	X	X													X	X		20N 21W		R/W ELECTRIC TRANSMISSION LINE	A-14908	5/15/1981	TO TERM 5/14/2011, AMENDED 9/14/1983,		
4									X	X	X	X	X	X	X	X	1-12		PLO PART REV RECL WDL COLORADO RIVER STORAGE PROJECT, 10/16/1931	5863	5/21/1981	(A-9735), OPEN TO MINERAL LEASING,			
26																		ALL,							
28																		ALL,							
30												X			X	X	4								
31	X	X	X	X	X				X	X			X	X	X	X	1-4								
34																		ALL,	2632 39	APLN / IL	A-17000-I	8/27/1981	SEGREGATED FROM THE PUBLIC LAND LAWS, INCLUDING THE MINING LAWS, BUT NOT THE MINERAL LEASING LAWS,		
4																		ALL EXCEPT PART OF MS 3814, MS 3985, AND MS 3847,							
9					X	X												N2SENW,							
33																		ALL,	1390 00	APLN / IL	A-17000-J	8/27/1981	SEGREGATED FROM THE PUBLIC LAND LAWS, INCLUDING THE MINING LAWS, BUT NOT THE MINERAL LEASING LAWS,		
31																	PART 4			LEASE / R&PP	A-17519	12/29/1981	EFF 1/11/1982, TERM 12/31/1986, CANC AND CASE CLOSED 3/17/1983,		
31																	PART 4			LAND USE PERMIT	A-17519-A	2/22/1982	EFF 3/15/1982, TERM 12/31/1986, CASE CLOSED 12/31/1986,		

TOWNSHIP 21 NORTH RANGE 21 WEST OF THE GILA & SALT RIVER MERIDIAN, ARIZONA

SECS	SUBDIVISION																Acres	Kind of Entry or Purpose	Serial Number or Order Number	Action Date	Remarks		
	NE 1/4				NW 1/4				SW 1/4				SE 1/4									Lots	Other Description
	NE	NW	SW	SE	NE	NW	SW	SE	NE	NW	SW	SE	NE	NW	SW	SE							
For orders affecting disposal or use of unidentified lands withdrawn for classification, minerals, water and/or other public purposes, and Indian treaties, refer to Index to Miscellaneous Documents																							
3									X	X	X	X							R/W ELECTRIC DISTRIBUTION LINE	A-17613	3/29/1982	TO TERM 3/28/2012, AMENDED 8/14/1989,	
1									X	X	X	X	X	X	X	X	1-12						
14																		ALL,					
26																	2044 64	LEASE / OG	A-14392	4/7/1982	EFF 5/1/1982, TERM 5/1/1985, OG SIM PART DEC 1985,		
3									X	X	X	X						EXCEPT PATENTED MC,	R/W BURIED AND AERIAL TELEPHONE CABLE	A-17787	5/12/1982	TO TERM 5/21/2019, AMENDED 5/22/1989,	
2													X	X			1-12	EXCEPT PATENT 1034423,					
3									X	X	X	X	X	X	X	X	1-12	EXCEPT PATENTS 1034423, 934419, 1007192,					
10					X	X	X	X	X	X	X	X	X	X	X	X		EXCEPT PATENT 934419,					
11					✓				X	X	X	X				X							
12	X	X	X	X	X	X	X	X	X	X	X	X				X		EXCEPT PATENT 957225,					
13					X	X			X	X	X	X						21N 20W	2351 40	LEASE / OG	A-17574	6/25/1982	EFF 7/1/1982, TERM 7/1/1983, OG SIM PART AUG 1984,
2											X												
3									X	X	X	X	X	X	X	X							
11	X	X	X	X	X	X	X	X															
12	X	X	X	X	X	X	X	X	X														
31	X	X	X	X	X	X			X	X			X	X	X	X	1-4		R/W WATER PIPELINE	A-17812	7/29/1982	TO TERM 7/28/2012,	
30	X	X		X					X	X						X	1-3	EXCEPT A STRIP OF LAND 300 FT IN WIDTH LANDWARD FROM THE EXISTING BANK OF THE COLORADO RIVER,	293 06	PLO REV COLORADO RIVER STORAGE PROJECT, SO 10/16/1931	6338	9/20/1982	9S 25W,
26																		ALL,					
34																		ALL,	IL 570	A-17000-I	9/30/1982		
28																		ALL,					
30																X	4	N2NESES, SWNESES, W2SESW, NWSESES, S2SESES, E2SWSE E2NWSWSE, NWNWSWSE, NESWSWSE, S2SWSWSE,	766 78	PLO PART REV COLORADO RIVER STORAGE PROJECT SO 6/4/1930 AND SO 10/16/1931,	6471	9/26/1983	(A-18433), CL FOR SS, LD TP 10N 18W,
28	X	X	X	X	X	X	X	X	X	X	X	X	X	X	X	X		NESWNW, S2NWSWNW S2SWNW,	635 00	IL 582	A-17000-I	9/28/1983	
30																X	4	N2NESES, SWNESES, W2SESW, NWSESES, S2SESES, E2SWSE E2NWSWSE, NWNWSWSE, NESWSWSE, S2SWSWSE,	126 78	IL 584	A-17000-J	9/28/1983	LD TP 10N 18W,

TOWNSHIP 21 NORTH RANGE 21 WEST OF THE GILA & SALT RIVER MERIDIAN, ARIZONA

SECS	SUBDIVISION																Acres	Kind of Entry or Purpose	Serial Number or Order Number	Action Date	Remarks			
	NE 1/4				NW 1/4				SW 1/4				SE 1/4									Lots	Other Description	
	NE	NW	SW	SE	NE	NW	SW	SE	NE	NW	SW	SE	NE	NW	SW	SE								
For orders affecting disposal or use of unidentified lands withdrawn for classification, minerals water, and/or other public purposes, and Indian treaties, refer to Index to Miscellaneous Documents																								
3									X	X	X	X							R/W BURIED WATER PIPELINE	A-18917	10/31/1983	TO TERM 10/30/2013,		
28																		M&B IN NE,	5 00	DEED OF RECON	A-20349	6/28/1985	OPEN TO MINERAL LEASING 8/30/1985,	
28																		N2NWSWNW,	5 00	PATENT / SX	02-85-0054	6/28/1985	(A-20349),	
28																		M&B IN NE,	5 00	OPENING ORDER	A-20349	8/30/1985	OPEN TO MINERAL LEASING ONLY,	
28																		M&B IN NENE,	5 00	O CL / R&PP	A-19287	9/27/1985	NOT OPEN TO MINERAL LEASING,	
28																		M&B IN NENE,	5 00	LEASE / R&PP	A-19287	1/27/1986		
30																		M&B IN W2SW,		R/W EASEMENT	A-23487	6/20/1986	TO TERM 6/19/2036,	
31	X	X	X	X	X	X			X	X			X	X	X	X	1-4			PATENT / CORRECTIVE	02-87-0021	3/31/1987	(A-10876),	
16																		ALL,	640 00	NORA	A-22439	4/2/1987	SEGREGATES THE LANDS FROM ALL FORMS OF APPROPRIATION UNDER THE PUBLIC LAND LAWS, INCLUDING THE MINING LAWS BUT NOT THE MINERAL LEASING LAWS, SEG TO TERM 4/1/1989,	
11																		M&B,						
12																		M&B,	58 69	APLN / ME PATENT	A-23007	3/10/1988	SEGREGATES THE LANDS FROM THE PUBLIC LAND LAWS, MINING LAWS, AND MINERAL LEASING LAWS,	
16																		ALL,	640 00	PATENT / PX	02-89-0013	12/30/1988	(A-22439),	
3									X	X	X	X							1 49	R/W ACCESS ROAD	AZA-23684	3/2/1989	EFF 11/1/1988, TO TERM 11/31/2018,	
30																		SENESESW, NWSESESW, SWNWSWSE, NWSWSWSE,	0 257	R/W CHAIN LINK PERIMETER SECURITY FENCE	AZA-25271	7/19/1991	TO TERM 7/18/2041,	
28																		M&B,	5 00	PATENT / R&PP	02-97-0001	3/4/1997	(AZA-19287),	
18									X			X												
19					X			X					X	X				E2NESW,		R/W FIBER OPTIC COMMUNICATION SYSTEM	AZA-30316	6/4/1999	TO TERM 10/16/2036, LD TP 1N 4W,	

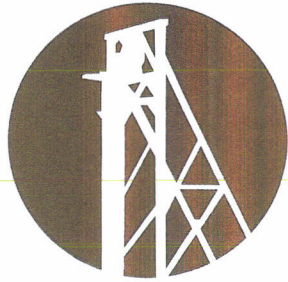

GOLD RUSH
EXPEDITIONS
2091 E. MURRAY HOLLADAY RD, STE. 22E
SALT LAKE CITY, UTAH 84117

CERTIFIED MAIL



7015 0640 0003 5824 1349



\$4.45
US POSTAGE
FIRST CLASS
PERMIT NO. 1138
PHOENIX, AZ

BLM RECEIVED
STATE OFFICE
2016 NOV 18 P 2:34
PHOENIX, ARIZONA

Arizona BLM
Attn: Cashier
One N. Central Ave., Ste. 800
Phoenix, AZ 85004

